

SPRAY CHARACTERISTICS

- Hollow cone spray producing uniform spray distribution.
- Coarse atomisation with the elimination of finer droplets.
- Nominal spray angle of 120°-140°.

CONSTRUCTION AND MATERIALS

- Right angle configuration.
- Two piece design (body and cap) with no internal vanes.
- Patented dual swirl chamber to produce "RAINDROP" type spray.
- Aerated droplets for the cleaning and purification of water.
- Wide open passages for reduced clogging.
- Available in 1/4" and 3/4" NPT Male thread only.
- Available in Nylon and Stainless Steel only.

ORDER EXAMPLE

3/4" RA 80 Nylon.



DIMENSIONS AND WEIGHTS - STAINLESS STEEL

Thread Size	Nozzle Number	Dimensions (mm)			Weight (g)
		A	B	C	
1/4	2	29	16	21	43
1/4	4, 5, 6	29	16	26	45
1/4	8, 10	29	16	33	45
3/4	20	54	32	63	332
3/4	30	54	32	60	329
3/4	50	54	32	69	335
3/4	80, 100	54	32	85	690
3/4	160, 200, 280	54	38	107	850

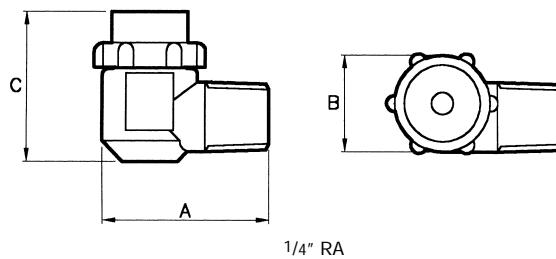

1/4" RA

DIMENSIONS AND WEIGHTS - NYLON

Thread Size	Nozzle Number	Dimensions (mm)			Weight (g)
		A	B	C	
1/4	2	33	19	25	7
1/4	4, 5, 6	33	19	30	7
1/4	8, 10	33	19	38	7
3/4	20	69	42	70	70
3/4	30	69	42	70	70
3/4	50	69	42	70	70
3/4	80, 100	69	42	79	70
3/4	160, 200, 280	69	42	92	70

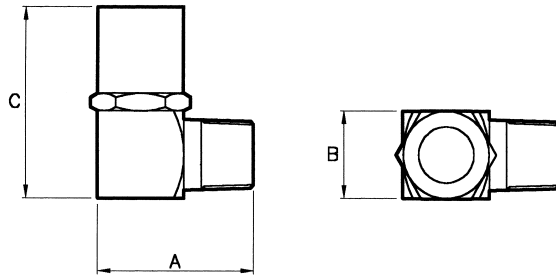

3/4" RA

Maximum Recommended Pressure:
14 Bar.G. (Metal), 7 Bar.G. (Nylon).
Maximum Recommended Temperature: 50°C (Nylon).

CAPACITY CHART

NOZZLE NUMBER	APPROX. ORIFICE DIA. (mm)		NPT THREAD SIZE		FLOW RATE IN LITRES/MIN AT Bar.G.							SPRAY ANGLE (°) AT 3 Bar.G.
	Outlet	Inlet	1/4	3/4	1,5	2	3	4	5	6	7	
RA 2	1,2	2,0			0,55	0,64	0,79	0,91	1,0	1,1	1,2	120
RA 4	2,4	2,0			1,1	1,3	1,6	1,8	2,0	2,2	2,4	120
RA 5	2,4	2,8			1,4	1,6	2,0	2,3	2,5	2,8	3,0	120
RA 6	2,4	3,2			1,7	1,9	2,4	2,7	3,1	3,4	3,6	120
RA 8	4,0	2,4			2,3	2,6	3,2	3,6	4,1	4,5	4,8	120
RA 10	4,0	3,2			2,8	3,2	3,9	4,6	5,1	5,6	6,0	120
RA 20	6,0	5,6			5,5	6,4	7,9	9,1	10,2	11,2	12,1	140
RA 30	9,1	5,6			8,3	9,7	11,8	13,7	15,3	16,8	18,1	140
RA 50	10,3	7,1			13,8	16,1	19,7	22,8	25,5	27,9	30,2	140
RA 80	15,9	7,5			22,5	25,8	31,6	36,5	40,8	44,7	48,2	140
RA 100	15,9	8,3			28,0	32,2	39,5	45,6	51,0	55,8	60,3	140
RA 160	20,7	10,3			44,6	51,6	63,2	72,9	81,5	89,3	96,5	140
RA 200	20,7	11,5			55,7	64,5	79,0	91,2	102	112	121	140
RA 280	21,0	13,5			78,2	90,3	111	128	143	156	169	140

NOTE: There are many other nozzle sizes between the 3/4" RA 20 and the 3/4" 280 and information is available from the factory.

HOLLOW CONE SPRAY

TYPE RA

Contact our Helpline for any special requirements:
Tel: +44 (0) 151 424 6821
Fax: +44 (0) 151 495 1043
e-mail: sales@delavan.co.uk
Web: www.delavan.co.uk

